



ClimateRight™

Portable A/C & Heater For Small Outdoor Enclosures

Assembly and Instruction Manual

#CR-2500 shown below

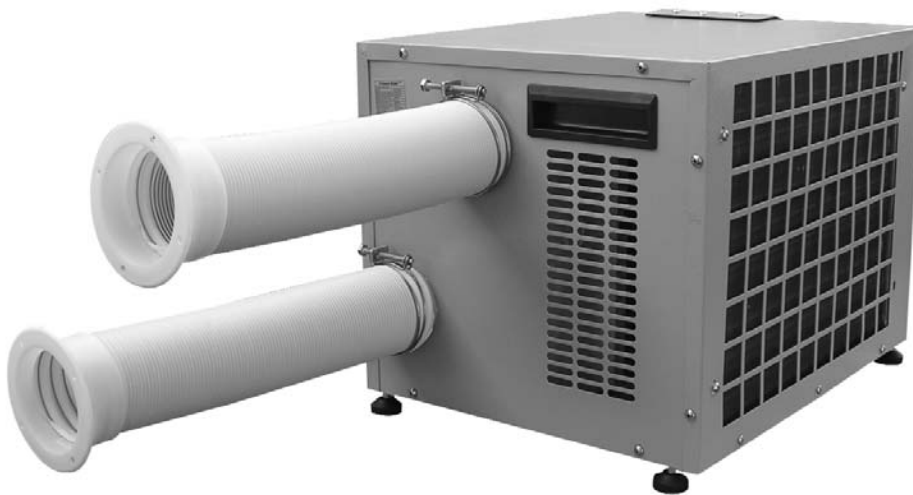

Models #CR-2500 and #CR-7000
Revised August 2011

Illustration of ClimateRight

(Same basic list of parts for both Models #CR-2500 and #CR-7000.) Model #CR-2500 shown below.



- 1. Protection shield
- 2. Control panel
- 3. Drain mouth (CR-7000 located in the bottom corner of unit)
- 4. Legs (or Casters for CR-7000)
- 5. Power cord
- 6. Handle
- 7. Clamp
- 8. Air outlet duct*
- 9. Air inlet duct*

*Hoses included in assembly kit. Shown here installed for illustration purposes.

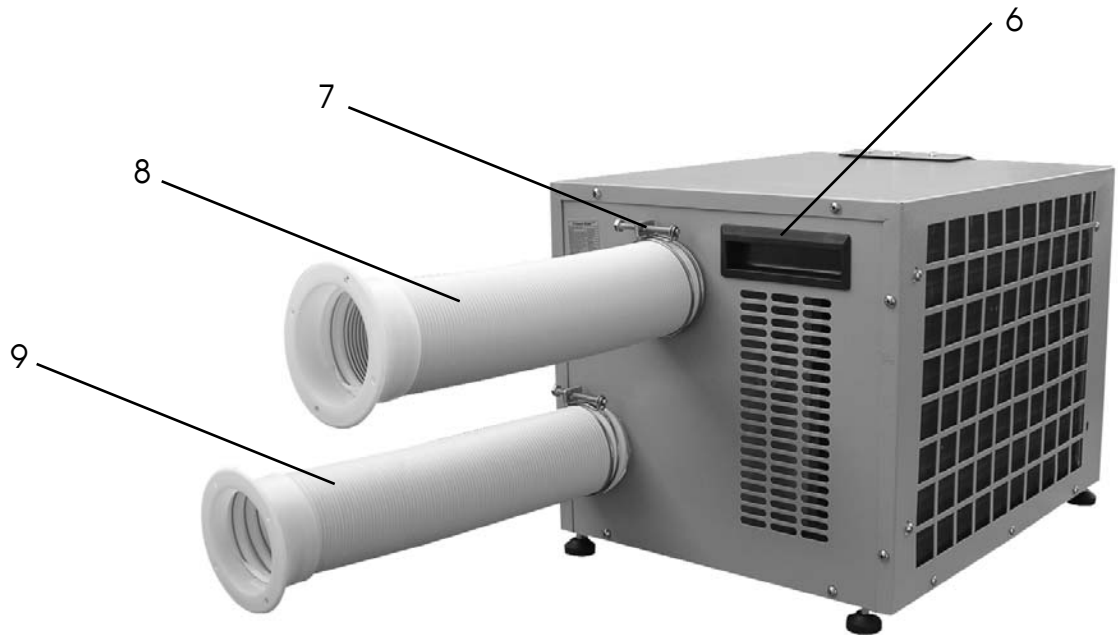

Accessories

The Accessory Kit includes parts needed to implement the 2-Hose System of air intake and air outflow for many small outdoor enclosures. See INSTALLATION INSTRUCTIONS. This hose installation method may be used for a variety of outdoor enclosures including pet houses and sheds. For other installations including tear drop trailers, boat cabins, enclosed tents, RVs, etc., some additional tools and your own "creativity" are required. Climate Right™ is working on new accessory kits for wide applications. Please tell us your application!

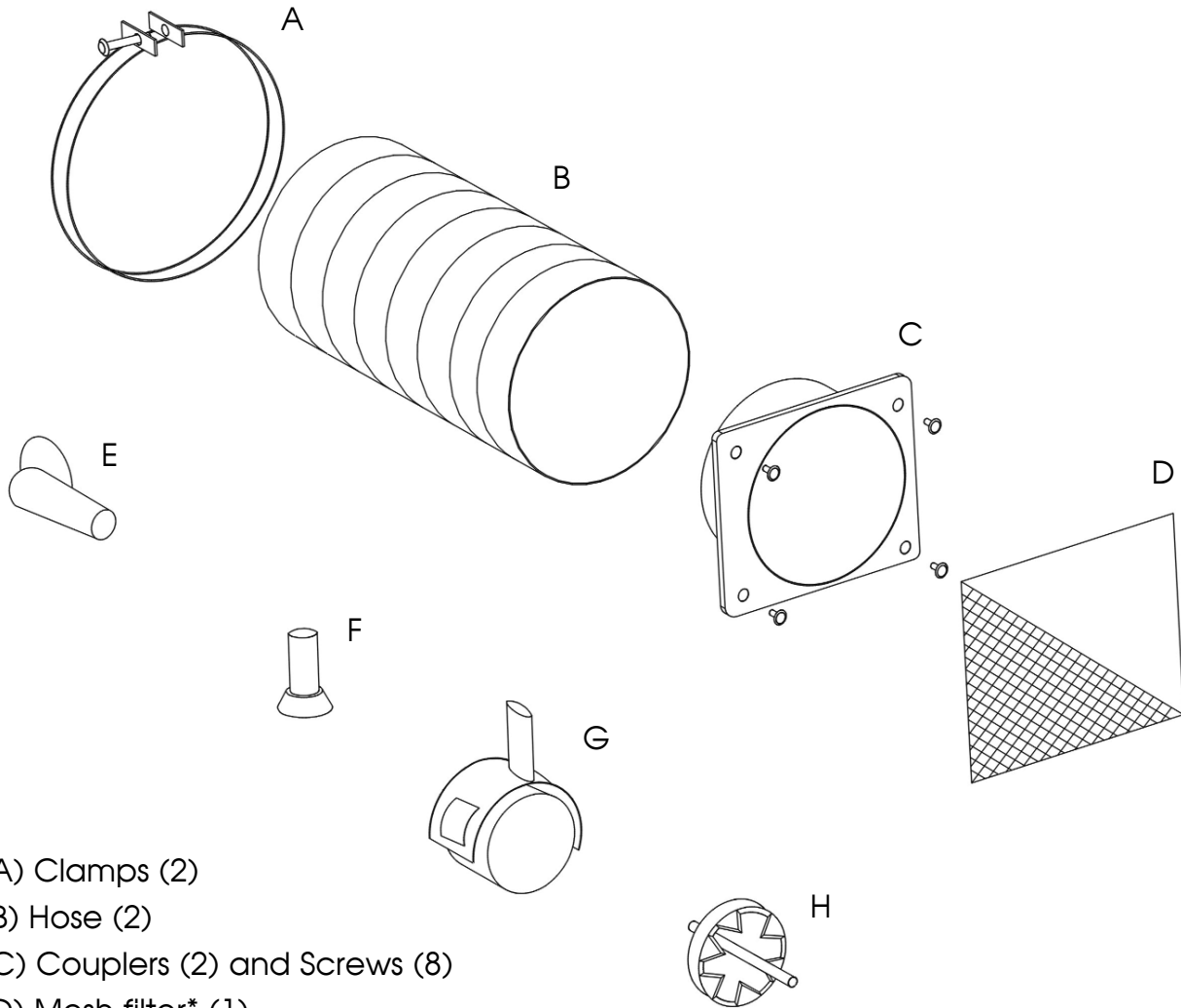

- A) Clamps (2)
- B) Hose (2)
- C) Couplers (2) and Screws (8)
- D) Mesh filter* (1)
- E) Drain mouth
- F) Foot (4)
- G) Wheels (4) (Note: Included in #CR-7000 only)
- H) Hole Saw (1) (Note: The size is a little smaller than the hose)

*Mesh filter maybe be placed in hose during packing.

Installation Instructions

Step 1

Use your common drill and attach the hole saw we have provided.



Step 2

Drill first hole 16" away from unit for air inlet duct.



Step 3

Measure 12" over and 12" up from center of first drilled hole to stagger air flow.



Step 4

Drill 2nd hole for air outlet duct.



Step 5

Insert hose inside coupler and twist to tighten.



Step 6

Place mesh filter between enclosure and coupler. Then screw coupler assembly over upper air outflow hole.



Installation Instructions

Step 7

Screw in lower coupler and hose for air intake.

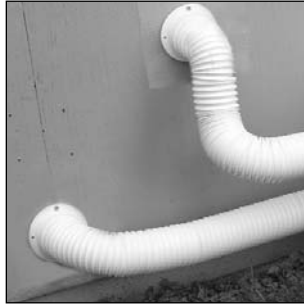

Step 10

For additional protection for the control panel screw on protection shield.

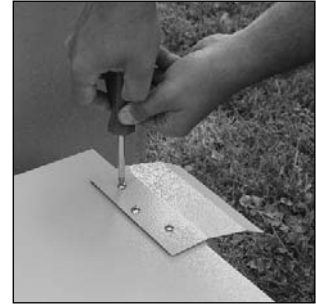

Step 8

With the ClimateRight™ unit placed on a flat surface connect hoses to unit.

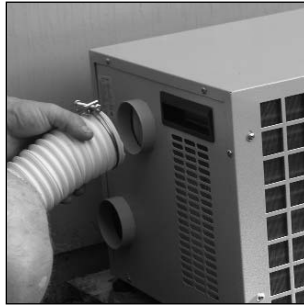

Step 11

Plug in unit. Carefully follow instructions in Operation section of this manual.

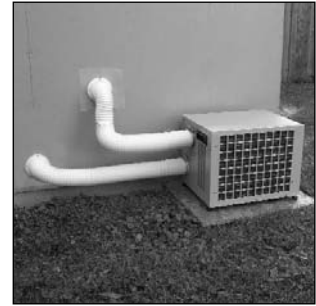

Step 9

Tighten hoses to the unit with clamps provided with a screw driver.

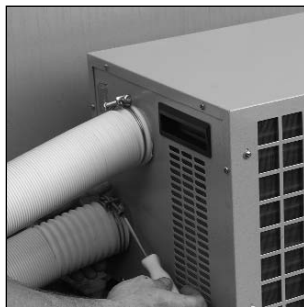

Operation

Note: CR-2500 and CR-7000 operate the same unless specified.

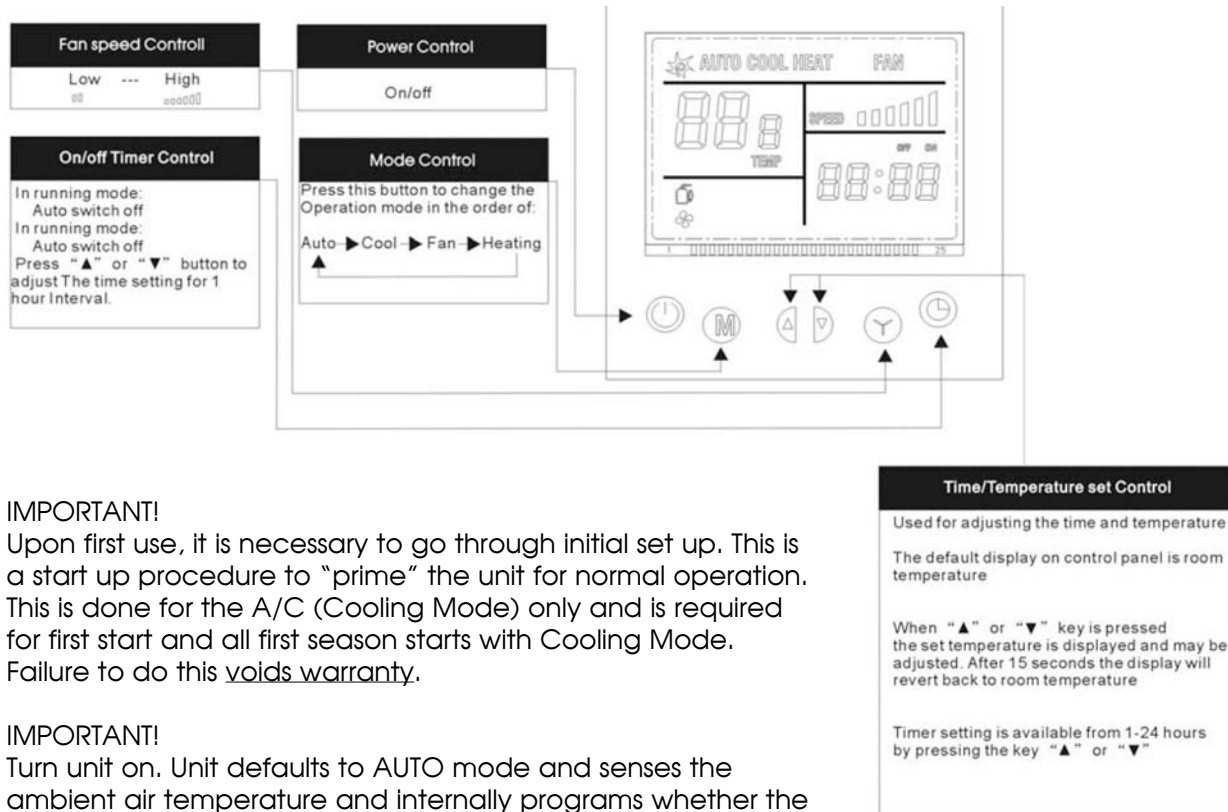

IMPORTANT!

Upon first use, it is necessary to go through initial set up. This is a start up procedure to "prime" the unit for normal operation. This is done for the A/C (Cooling Mode) only and is required for first start and all first season starts with Cooling Mode. Failure to do this voids warranty.

IMPORTANT!

Turn unit on. Unit defaults to AUTO mode and senses the ambient air temperature and internally programs whether the cooling or heating mode should be the default. After initial power up, DO NOT USE AUTO MODE. Set the unit manually to either COOL (in hot weather) or HEAT (in cold weather) Then set desired temp.

Start-up-Prime Unit First:

First please turn on the unit and set to lowest possible Cooling or Automatic setting. Let unit run for 10 minutes and shut off. Let unit sit idle for 3-5 minutes and restart. Make sure on restart to have the lowest temperature set and let run for an additional 10 minutes. This will distribute the A/C oil to all the necessary areas for proper function and allow the compressor to run at its optimum for long life and maximum efficiency.

Operation:

Once unit is primed, you no longer use AUTO mode. Set unit to either COOL, HEAT or FAN mode. Then set desired temperature.

Operating Functions of your Climate Right™:

Your climate unit is designed to condition the climate of your air in three ways: Cooling (A/C), Heating and Fan Only. The unit will operate in only one mode at a time. These modes should be set manually. There are two (low/high) fan speeds.

If the OUTSIDE Temperature falls below the set temperature in some instances the CPU will turn off the fan.

When it's required again the CPU will turn the fan back on. This is normal operation to save energy. While operating the cool mode it is normal for the unit to produce "condensation" or water must drain out the bottom. If this cont...

Operation, cont...

climate unit will be used indoors it is a must that a separate drain pan (NOT INCLUDED) be installed under the unit. Please take this into consideration when mounting or installing the unit. Your ClimateRight™ may produce large amounts of condensation depending on humidity levels. (Note: Drain mouth location differs on each model).

Timer:

You may set the timer to control how long your Climate Right™ runs. The Time Display shows the number of hours remaining until unit shuts off. When the unit is operating, you can set the OFF time by adjusting the number of hours of operation (using "Up" and "Down" button). When the unit is turned off, you can START time within a range of 1 to 24 hours from when you set it.

Maintenance:

Your Climate Right™ climate control unit should be a low maintenance product and not require much attention if used in normal environments. However, over time with normal usage there are two (2) things that may need to be addressed.

Filters: If used in the inlet and outlet pipes they will get dirty over time. Please remove and clean as desired.

Condenser: On the right side of the unit there is the condenser. If you notice the cooling ability of the unit degrading or if the fins of the condenser become dirty they will need to be cleaned. Compressed air should be used to gently blow the unit out.

Note:

Failure to properly care for your Climate Right™ unit as mentioned above will result in the Warranty to be voided.

Uses:

Climate Right™ can be used in a variety of ways. The possibilities are endless. We have many customers who currently use the unit for climate conditioning of dog houses, boat cabins, toll booths, tents, tear drop trailers, personal cooling in hot or cold environments, electronic equipment, cabanas, small wine cellars, cigar storage rooms and many more! Climate Right™ was designed using the best components such as Toshiba® and Hitachi® compressors and brass piping to ensure whatever your use, it will condition your climate efficiently, reliably and quietly!

Wiring and Specifications

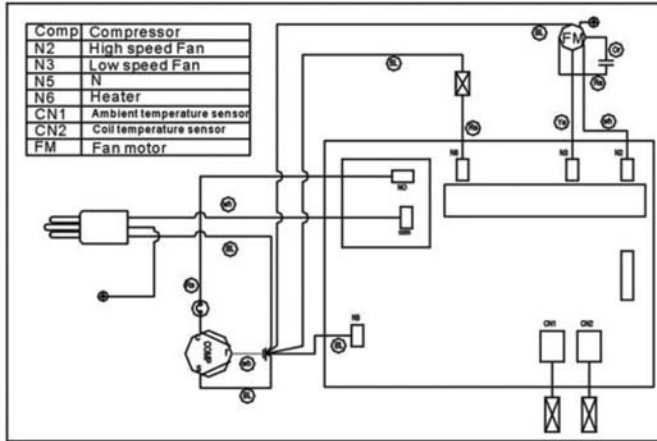

#CR-2500

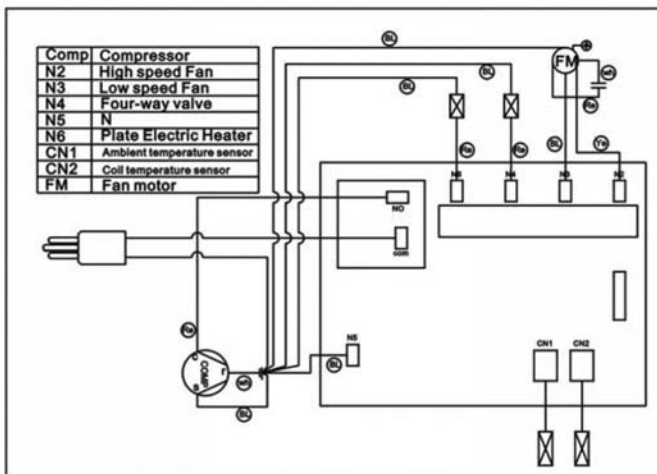

Climate Right™	
Portable air conditioner and heater	
Model	CR-2500
Rated Cooling capacity	2500 BTU
Rated Heating capacity	1800 BTU
Rated Cooling input	460 W
Rated Cooling current	4.2 A
Rated heating input	650 W
Rated heating current	5.9 A
Air Flow Volume	130 CFM
Refrigerant	134A
Rate voltage	115V/60HZ
Locked Rotor Current	6.7 A
Max Working pressure	2.0 Mpa
Diameter of Duct	3.1 "
Weight	43 lb
Net size	22"X15"X14"
Waterproof class	IPX4
Room size	5-350 cu. ft.
 	

#CR-7000



Climate Right™	
Portable air conditioner and heater	
Model	CR-7000
Rated Cooling capacity	7000 BTU
Rated Heating capacity	7500 BTU
Rated Cooling input	860 W
Rated Cooling current	7.6 A
Rated heating input	890 W
Rated heating current	7.9 A
Air Flow Volume	260 CFM
Refrigerant	R410a
Rate voltage	115V/60HZ
Locked Rotor Current	14 A
Max Working pressure	4.0 Mpa
Diameter of Duct	4.7 "
Weight	60 lb
Net size	27"X18"X15"
Waterproof class	IPX4
Room size	350-1,200 cu. ft.
 	

*Keep your Climate Right™ protected from extreme hot direct sun. Results very widely depending on ambient air temperature, size of enclosure and insulation. The Climate Right™ is intended for temperatures are between 5° F and 109° F.

Accessory Part Specs

#CR-2500

Item	No of pcs	Diameter (inches)	Length (inches)
Hose	2 hoses	Inner Dia. : 2.75" ; Outer Dia : 3.15"	40"
Hole saw	1 pc	2.75" Dia.	
Couplers	2 pcs	3.15" Dia.	
Clamps	2 pcs	3.4" Dia	
Mesh filter	1 pc	7.5" x 7.5"	
Screws	8 pcs	0.16" x 0.47"	
Foot	4 pcs		
Wheel	4 pc		
Drain mouth	1 pc	0.78" Dia	Located bottom center

#CR-7000

Item	No of pcs	Diameter (inches)	Length (inches)
Hose	2 hoses	Inner Dia. : 4.3" ; Outer Dia : 4.7"	40"
Hole saw	1 pc	4.5" Dia.	
Couplers	2 pcs	4.7" Dia.	
Clamps	2 pcs	4.9" Dia	
Mesh filter	1 pc	7.5" x 7.5"	
Screws	8 pcs	0.16" x 0.47"	
Foot	4 pcs		
Wheel	4 pc		
Drain mouth	1 pc	0.78" Dia	Located bottom corner



Hose



Hole Saw



Coupler/Screws



Clamp

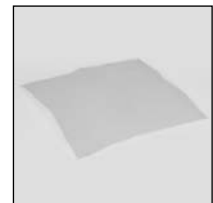

Mesh Filter



Foot



Wheel



Drain Mouth

ClimateRight™ FAQ— Models #CR-2500 and #CR-7000

©Revised August 2011 — Tacom Limited

What is Climate Right™? Climate Right™ is a portable, electrical, outdoor small enclosure air conditioner, heater and humidity control system — all in one. There are two (2) models, but both operate on the same general principals. ClimateRight™ is designed to be connected to outdoor enclosures with a two-hose air intake/outflow accessory kit (included). Simply set the unit outside an outdoor small enclosed structure, install the 2 hoses into the structure using our simple Accessory Kit, turn on, set it to your desired heat or cool mode and temperature, and enjoy!

What types of enclosures does Climate Right™ work with? It depends on the CUBIC FOOTAGE of your enclosure:

CR-2500: Any outdoor enclosure 5-350 cubic feet like pet houses, small work sheds, tear drop trailers, toll booths, tents, or any small outdoor installations or enclosures.

CR-7000: Any outdoor installations or enclosures 350-1,200 cubic feet such as sheds, garages, job site trailers, outdoor recreation or work spaces, etc. This unit is also ideal to spot cool or heat economically and effectively.

What is the difference between CR-2500 and CR-7000? The main difference is the btu power. CR-2500 is rated for small enclosures 5-350 cubic feet. CR-7000 is rated for enclosures 350-1,200 cubic feet. Multiply the approximate L' x W' x H' of your enclosed space and then select the proper model based on this. Be sure not to assume bigger is better! Performance and satisfaction depends on selecting the proper unit for the size of the space.

How Do I Install Climate Right™? Using our Accessory Kit. It is a 2-Hose System for air intake and air outflow. (See "Figure 1 — Climate Right™ Cooling/Heating Process.") We include an Assembly Kit for pet houses, or many outdoor enclosures. Note that the Assembly Kit is designed to work on most wooden pet houses. The air intake/outflow system depends on having an inlet hole and outlet hole that fits the coupler/hose system. Your application may not be a wood pet house. In this cases, you will need to seek professional installation advice and possible special

tools and fittings to optimize your application for the unit. (We are working on a new accessory kits!)

IMPORTANT NOTE: Climate Right™ can be used in a wide variety of applications, with varying degrees of beginning ambient temperature, enclosure sizes, insulation, humidity, etc. Therefore, the intent of the unit is to improve the conditions generally. In all cases, the climate will markedly improve. However, we cannot guarantee or warrant your space will heat or cool to the exact set temperature. Fan speeds two temperatures (low/high)

Can I leave Climate Right™ OUTDOORS? Yes. The electrical work is enclosed and safe from the elements. The unit is specially designed to operate outdoors in the elements.

Can I use Climate Right™ INDOORS? Yes. You just should make sure there is a venting system for heat to escape using cooling mode. Ideally, use the 2-Hose system (air intake and outflow to properly "replenish" acclimatized air).

How Does Climate Right™ actually heat and cool? There are two ports located on the front of the unit. On port #1 (lower), air is drawn into and sent to the inside of the unit where it is either heated or cooled. Then the air is forced by fan back out port #2 (higher), into the structure to be climate controlled. No heating elements or cooling elements (evaporator) are exposed to the outside. Both elements are contained within sealed cases located on the inside of the unit. This unit is not set up like a space heater and will not pose any sort of fire hazard if tipped over. (See "Figure 1 — Climate Right™ Cooling/Heating Process").

What is the temperature range for heating and cooling? Climate Right™ can be set to heat or cool from 61-87 degrees Fahrenheit. Climate Right™ can be set to heat mode, or cool mode. Do not use AUTO mode as this mode is a default setting during setup. Acclimatized temperatures vary depending on ambient air temperature and size of enclosure.

ClimateRight™ FAQ–, cont...

Models #CR-2500 and #CR-7000

IMPORTANT NOTE: Let Climate Right™ run for about 48 hours continuously for peak performance. Do not expect Climate Right™ to work in minutes, or even a few hours. It may take this amount of time to optimize your climate.

Can Climate Right™ be left on continuously?

Yes. You can use Climate Right™ continuously to help maintain temperature and humidity, or “spot” heat or cool while within an enclosure for shorter periods.

What comes included with Climate Right™? At the current time, the unit comes with a kit that contains two hoses, one hole saw, two couplers, two clamps, one mesh filter for return hose, and eight screws (optimal for dog and cat house cut out and assembly). Instructions and Warranty are also enclosed in the box. This kit can be used for any other wooden structure like an outdoor shed.

Why is Climate Right™ better for small spaces?

The CR-2500 unit runs with a smaller compressor than almost all bigger units on the market, and thus is not “overkill” with too much cold or too much hot. It optimizes the small climate space, with the bonus of very little energy consumption. The CR-7000 is a bit more capacity (btu) and blow force. Carefully select the unit based on size of enclosure (see What Types of Enclosures Work with Climate Right™).

Who makes Climate Right™? We manufacture in a state of the art manufacturing facility in China specializing in OEM electronic heating and cooling products, supplying both small and very large corporations. We use only first quality components such as Toshiba and Hitachi compressors, and brass piping.

How much energy does Climate Right™ use?

See specifications. This unit is considered a very low energy consumption electronic device.

Is there a Warranty? Yes. It is included in the box, and posted on our web site.

How long does it take to ship? Orders are normally shipped within two business days of receipt via either Fed-Ex or UPS ground. Expedited shipping will cost more, you must contact Tacom or your authorized dealer.

Where can Climate Right™ be used? The possibilities are nearly endless: outdoor dog and cat houses, tents, attics, small work spaces like job site trailers, garden sheds, garage work areas, tear drop trailers, boat cabins, temporary outdoor small military installations, toll booths, parking attendant houses, to name a few. Share with us your ideas!

Besides heating and cooling, does Climate Right™ improve air quality? Yes. The unit dehumidifies and cleans the air naturally. Filtration devices provide active control of air quality and help to eliminate airborne contaminants.

How does the thermostat work? A digital control panel with multiple setting options. See the temperature sensor is located inside ClimateRight™ and senses the ambient air temperature of your enclosure.

Troubleshooting? Consult the Troubleshooting section.

How long should the Climate Right™ last? The unit is rated for NEMA R-12 insulated enclosure. The unit should last 5-10 years under normal operating conditions.

Is Climate Right™ Safe for Pets? Yes. Note that a suitable ideal temperature for pets in the outside cold winter is 38-55 degrees. In the heat of summer, a range of about 75-82 degrees is considered acceptable.

Figure 1 – Climate Right™ Cooling/Heating Process

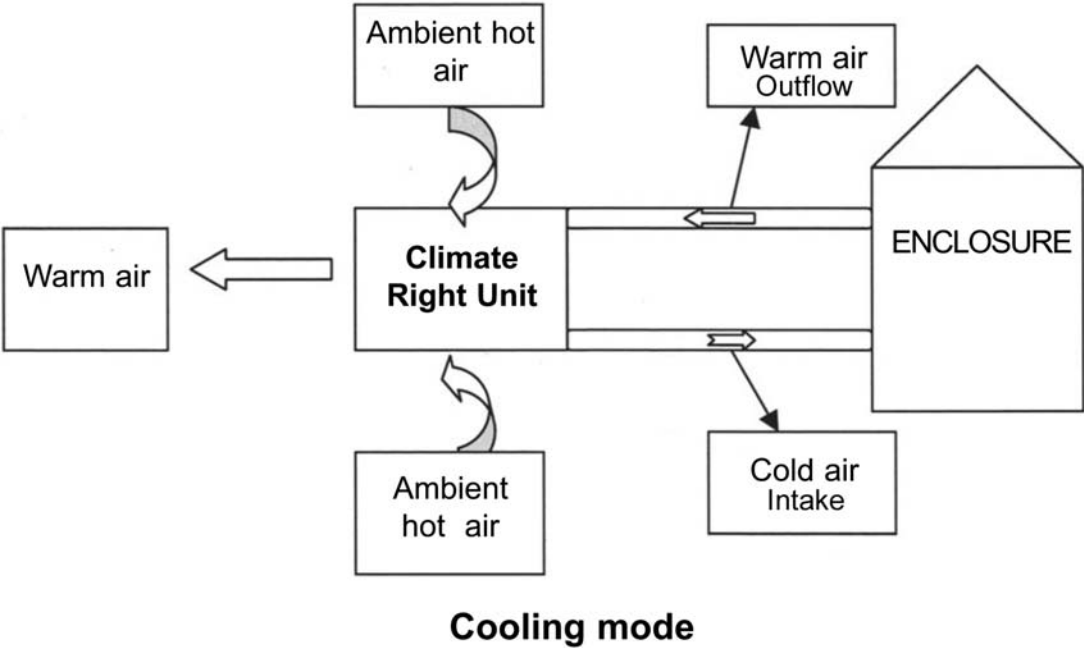
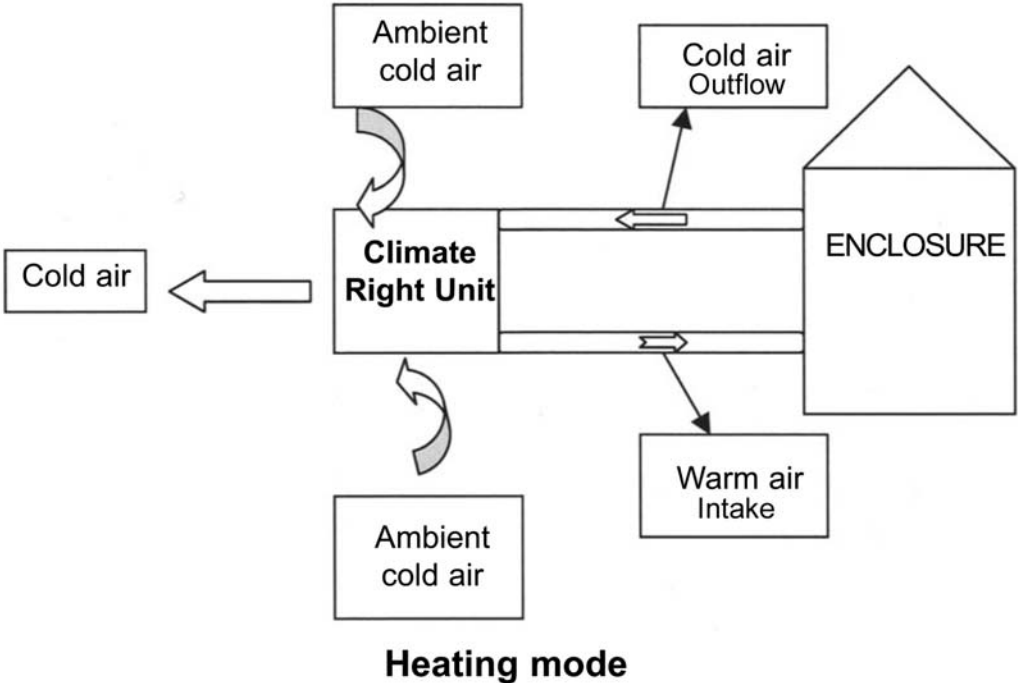

Troubleshooting

General Systems Diagnosis:

1. The unit does not power on. Check to see if unit is plugged in to normal wall 110/120v wall socket. Consult Troubleshooting telephone number below. This problem cannot be troubleshot by email. (It is likely that a connection on the internal control panel has become loose and will require careful guidance for safety reasons). Do not attempt to remove the unit casing and fix.
2. Fans are running but unit not cooling or heating. Consult Troubleshooting telephone number or email, whichever you prefer, below. This problem would likely be a capacitor or compressor issue, which would need to be handled by our qualified troubleshooting team.
3. Excessive vibration or noise. Consult Troubleshooting telephone number or email, whichever you prefer, below. This problem would likely be loose screws, or a loose compressor fitting, which would need to be handled by our qualified troubleshooting team.
4. Excessive noise coming from fan. Consult Troubleshooting telephone number or email, whichever you prefer, below. This problem would likely be a fan that has been "jolted" or "knocked loose" during shipping, which would need to be handled by our qualified troubleshooting team.
5. Cooling or heating function decreased. Check filter or condenser fins on the unit. Make sure filters and condenser fins are clean and free of debris or particles.
6. Display does not show temperature. Consult Troubleshooting telephone number or email, whichever you prefer, below. This problem would likely be control board or thermostat issue, which would need to be handled by our qualified troubleshooting team.
7. Fault codes:

Fault E01: Indoor temperature sensor fault, wiring or sensor.
Fault E02: Evaporator temperature sensor fault, wiring or sensor.

Consult Troubleshooting telephone number or email, whichever you prefer, below.
8. Hose assembly problems. Insure you have all parts listed in Assembly section. Follow the directions very carefully. (We have many calls about people trying to put hose OVER the coupler. It goes INSIDE the coupler. Also, the mesh filter is located inside one of the hoses).



Troubleshooting, cont...

9. Unit "overcools" or "overheats". Check recommended enclosure sizes for the unit. This can be found in the Operation section. Climate Right is not responsible, and does not warrant, miscalculations of your enclosure cubic footage, and mistakes made in selection of unit. CR-2500 works for 5-350 cubic foot enclosures. CR-7000 works for 350-1,200 cubic foot enclosures. This is meant to be an approximate guide and may vary case by case.

Troubleshooting Phone: 800-7-CLIMATE (800-725-4628 opt. 2)

Troubleshooting email: techsupport@theclimatecontrollers.com

Allow one business day for response. We strive for immediate help and satisfaction, however we are a small family owned business, with great, but (very helpful and capable) busy people who want to help you!

Summary

Thank you for your purchase and becoming one of the many people and pets to enjoy the benefits of the climate controlled air by ClimateRight™. We are confident that our unit will provide you with many years of comfort and peace of mind. If you have any questions or comments please feel free to contact us at: www.ClimateRightAir.com.